

Data sheet

Flow director 013G1522 for tube segment radiators - to be used with integrated valve 013L1384

Application



The Danfoss flow director 013G1522 is designed to be used with Danfoss integrated valve type 013L1384 for incorporation into tube segment radiators.

Tube segment radiators are constructed by a series of elements, which are welded together. The first segment is used as inlet pipe, while return is through the bottom of the second segment.

When integrated valves are used in tube segment radiators, the water flow needs to be directed correctly through the valve to avoid noise problems. This is made with the Danfoss flow director.

Code nos. and technical data

Flow director

| Flow director type | Connection radiator | Connection integr. valve | Max. water temperature | Code no. |
|----------------------------|---------------------|--------------------------|------------------------|-----------------|
| For tube segment radiators | 1¼" | ½" | 120 °C | 013G1522 |

Integrated valve for flow director

| Valve type | Differential pressure ¹⁾ | | Test pressure | Work. pressure | Max. water temp. | Code no. |
|------------------------------|-------------------------------------|-----------|---------------|----------------|------------------|-----------------|
| | Recom. | Technical | | | | |
| For Danfoss RTD type sensors | 0.05-0.2 bar | 0.6 bar | 16 bar | 10 bar | 120 °C | 013L1384 |

¹⁾ The technical differential pressure indicates the upper limit for a proper valve function. In most two-pipe systems the recommended differential pressure is sufficient. In order to achieve a noiseless function we recommend in smaller systems to apply automatic bypass valves or automatic balancing valves. If pump differential pressure exceeds the recommended max. valve differential pressure it is recommended that an automatic balancing valve type ASV-P/PV is added to the system.

Accessories and spare parts for integrated valve 013L1384

| | Code no. |
|---|-----------------|
| Gland seal | 013G0290 |
| Gland seal, resistant to rise in pressure because of water freezing | 013L0669 |
| Protection cap (red) | 013L3395 |

Pre-setting values, flow director + integrated valve

| Flow director + integrated valve | Presetting | | | | | | | | |
|---------------------------------------|-------------------------------------|------|------|------|------|------|------|------|-----------------|
| | k _v -value ²⁾ | | | | | | | | k _{vS} |
| | 1 | 2 | 3 | 4 | 5 | 6 | 7 | N | |
| Flow director 013G1522 + RTD 013L1384 | 0.12 | 0.16 | 0.22 | 0.27 | 0.38 | 0.47 | 0.59 | 0.72 | 1.18 |

¹⁾ k_v-values indicate the flow volume (Q) in m³/h at a pressure loss (Δp) across the valve of 1 bar. $k_v = Q / \sqrt{\Delta p}$. At setting N, the k_v-value in accordance with EN 215 can be stated as Xp = 2 K. At lower preset values, Xp will be reduced until approximately Xp 0.5 at presetting 1. The table shows the average measured values for integrated valves with radiator. The k_{vS}-values indicate the valve capacity, when the valve is fully open. If a remote temperature adjuster is used, the P-band is increased by a factor of 1.1. If an RTS is used, the P-band is increased by a factor of 1.2.

Design and dimensions

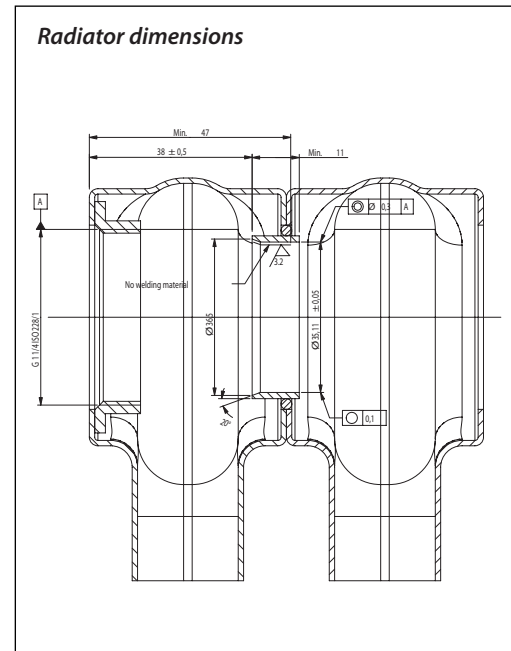
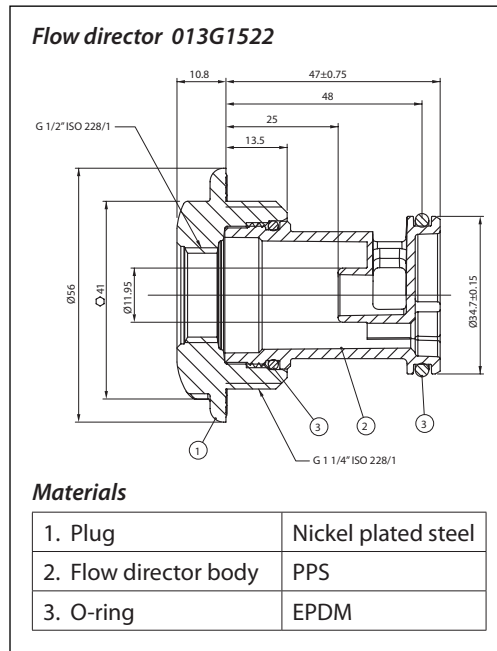

Capacities

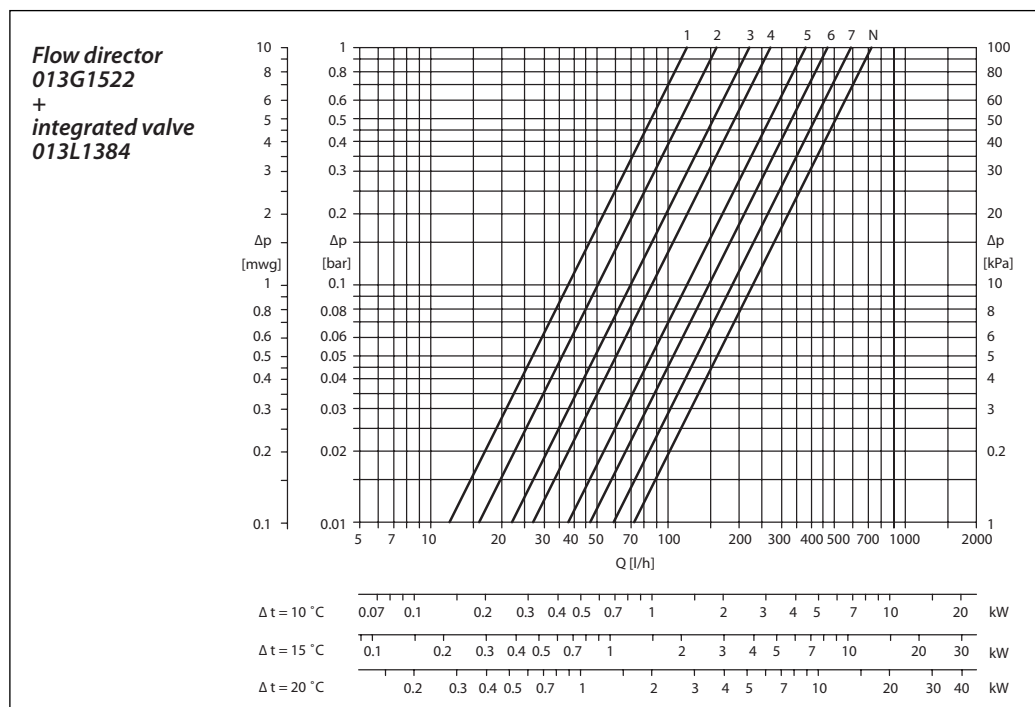

Danfoss can accept no responsibility for possible errors in catalogues, brochures and other printed material. Danfoss reserves the right to alter its products without notice. This also applies to products already on order provided that such alterations can be made without subsequential changes being necessary in specifications already agreed. All trademarks in this material are property of the respective companies. Danfoss and the Danfoss logotype are trademarks of Danfoss A/S. All rights reserved.